

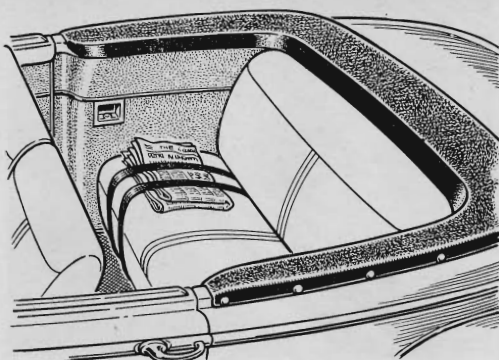

## Hints from the Model Garage



**Prevent Overinflation.** The new low-pressure tires are sometimes overinflated through carelessness. As a reminder to service-station attendants, paint the correct pressure on the rim beside each valve stem with white enamel, or apply waterproof adhesive tape with the figure inked on. You can also buy markers for your caps. See page 169.



### Straps Hold Back-Seat Items.

If you own a convertible, here's a hint that may be useful. David A. Wallace, of Ada, Mich., suggests that one or more elastic straps placed around the rear cushion will keep papers or loose clothing from blowing out while the top is down. The straps won't interfere with passengers.

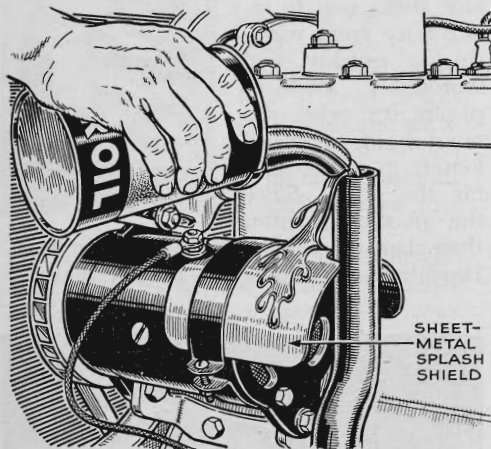

**Shield Protects Generator.** While filling up with oil, you may have noticed that the attendant sometimes allows a little to slop over the filler tube. Ray Wolfram, of Chicago, writes that he finally traced a mysterious generator trouble to such carelessness. Spilled over the generator, the oil had fouled the brushes. To prevent this from happening again, he installed a metal shield as shown.

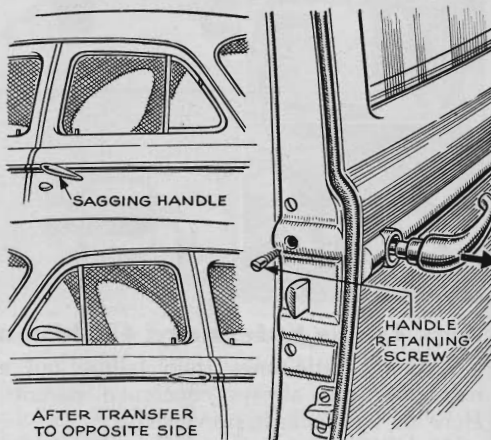

**Reverse Sagging Handles.** On some cars the door handles eventually wear enough so that they sag below the chrome strip they were designed to parallel. Don E. Braman, of Little Rock, Ark., found a simple solution for this on his 1941 Chevrolet. Removing the handles, he transferred each to the door on the opposite side. There, since the worn part was up, the handle didn't sag. Three minutes did the job.