

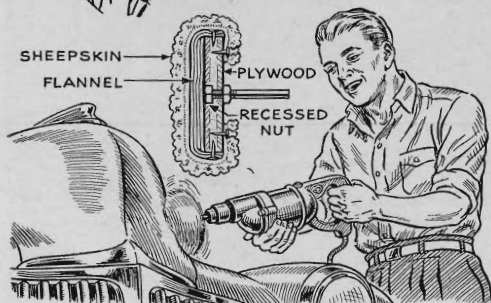

Hints From the Model Garage



Make Your Own Polishing Pad.

If you own an electric drill, it's a simple job to assemble a polishing attachment. Cut a 5" disk from $\frac{1}{2}$ " plywood, drill and counter-bore it, and attach a shaft cut from a $\frac{1}{4}$ " bolt. Pad the face with several layers of flannel. Finish it off with sheepskin cut from a polishing mitt, tacking along the back.

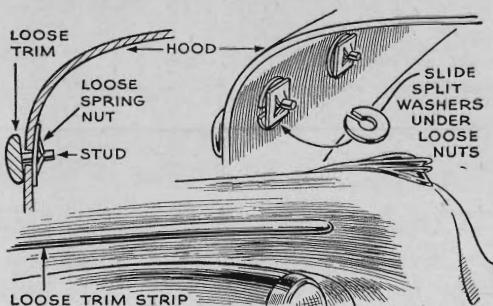

Washers Tighten Trim.

Chromium trim often is attached with unthreaded studs and flat spring nuts. In time, wear on the studs may loosen the nuts and allow the trim to rattle and squeak. One way of tightening it is suggested above. Cut a section from a steel washer. Then force the washer behind the nut to take up the slack.

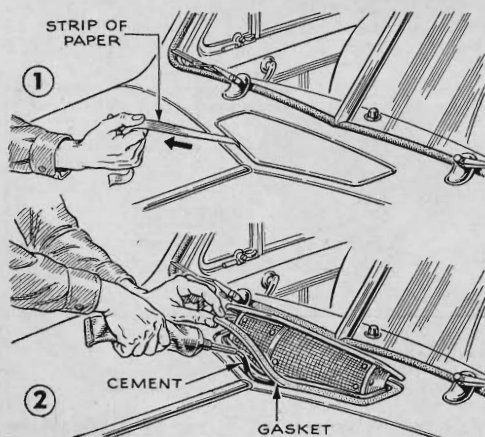

Repairing a Cowl Ventilator.

Water may leak through a cowl ventilator unless the lid makes firm and even contact with the gasket. If a strip of paper can be withdrawn when the lid is closed on it (1), increase the lid tension by shortening the adjusting link you'll find under the instrument panel. It's also sometimes helpful to remove the gasket, clean it and its channel, and carefully cement in place (2).

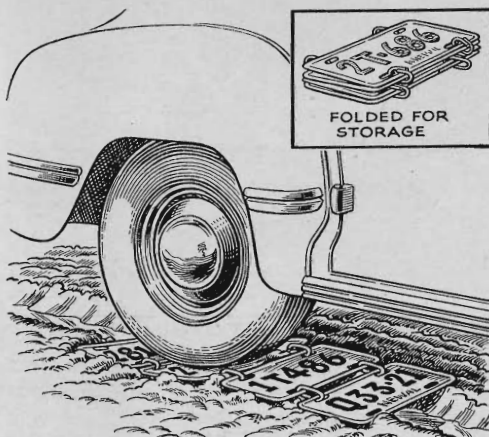

Plates Get You Out of Mud.

What do you do with your old license plates? Throw them away? Tack them on the garage wall? Herman Marcus, of Jamaica, N. Y., has a better idea. Link at least four of them together, using wire or perhaps chain-repairing links, fold them into a compact bundle, and store in the luggage compartment. Then if you ever get stuck in the mud, you've got a ready-made mud track.