

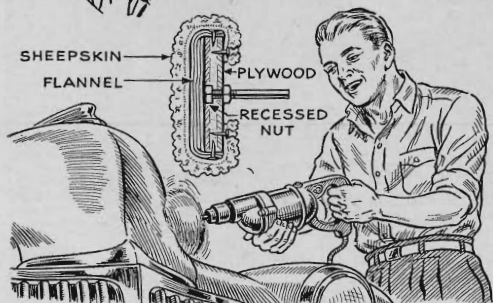

Hints From the Model Garage



Make Your Own Polishing Pad.

If you own an electric drill, it's a simple job to assemble a polishing attachment. Cut a 5" disk from $\frac{1}{2}$ " plywood, drill and counter-bore it, and attach a shaft cut from a $\frac{1}{4}$ " bolt. Pad the face with several layers of flannel. Finish it off with sheepskin cut from a polishing mitt, tacking along the back.

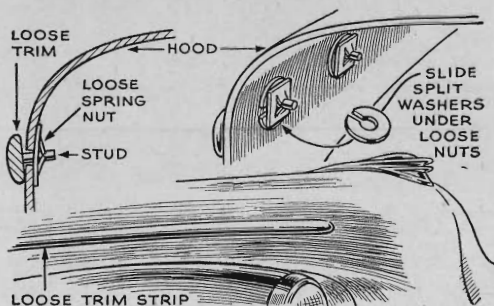

Washers Tighten Trim.

Chromium trim often is attached with unthreaded studs and flat spring nuts. In time, wear on the studs may loosen the nuts and allow the trim to rattle and squeak. One way of tightening it is suggested above. Cut a section from a steel washer. Then force the washer behind the nut to take up the slack.

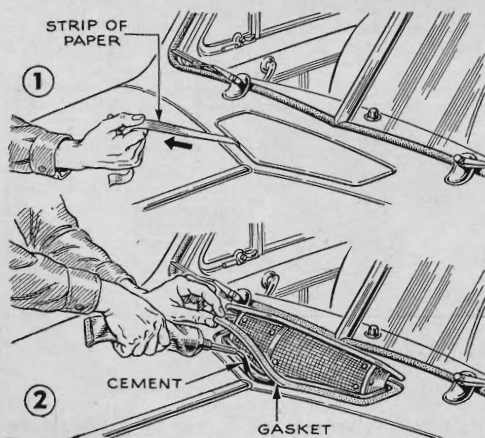

Repairing a Cowl Ventilator.

Water may leak through a cowl ventilator unless the lid makes firm and even contact with the gasket. If a strip of paper can be withdrawn when the lid is closed on it (1), increase the lid tension by shortening the adjusting link you'll find under the instrument panel. It's also sometimes helpful to remove the gasket, clean it and its channel, and carefully cement in place (2).

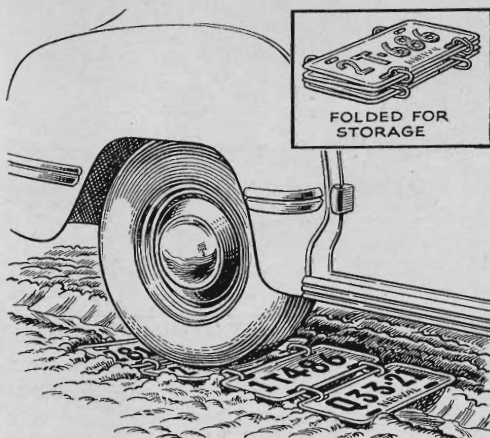

Plates Get You Out of Mud.

What do you do with your old license plates? Throw them away? Tack them on the garage wall? Herman Marcus, of Jamaica, N. Y., has a better idea. Link at least four of them together, using wire or perhaps chain-repairing links, fold them into a compact bundle, and store in the luggage compartment. Then if you ever get stuck in the mud, you've got a ready-made mud track.

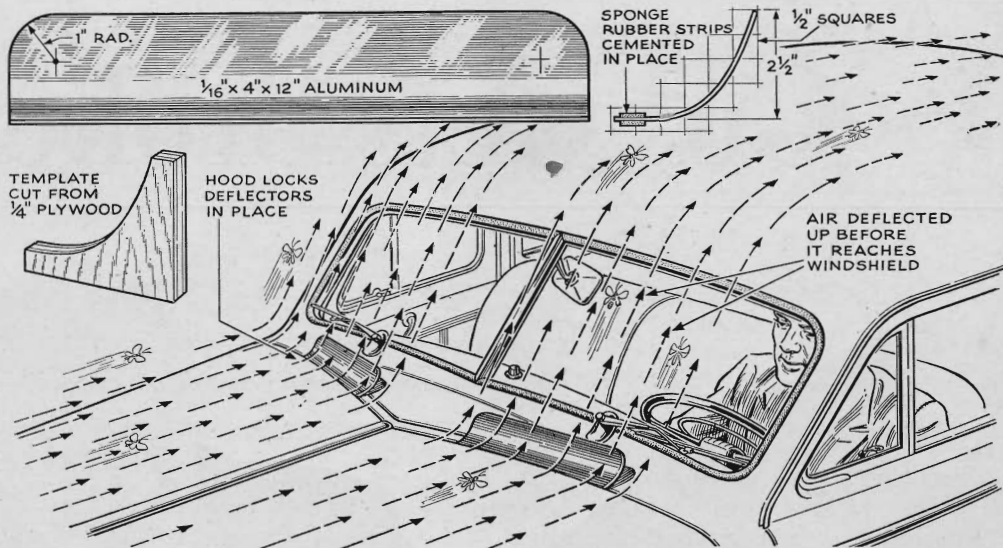

Bugs Kept Off Windshield. At this season, the spatter and smear of insects on a windshield makes seeing tough, especially at night. A. W. Schach, of Rockford, Ill., uses deflectors like these to overcome the problem. The sketch on $\frac{1}{2}$ " squares

shows the curvature that will deflect air over the roofs of most modern cars. Cut a plywood template to this curvature as a guide when bending the aluminum. Either polish the aluminum to a high luster or paint it to match the car.

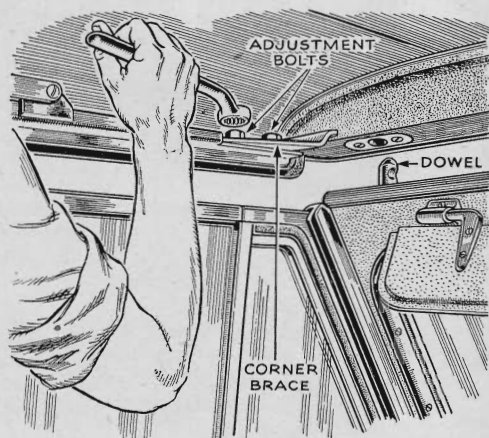

Adjusting a Folding Top. Convertible tops on General Motors cars may be adjusted either forward or back if the dowels don't hit their holes in the roof rail. First, unlatch the top and raise it slightly. Next, loosen the adjustment bolts. Then move the corner brace until the dowels and holes are properly aligned. In some cars, a different corner brace is used, but the adjustment is essentially the same.

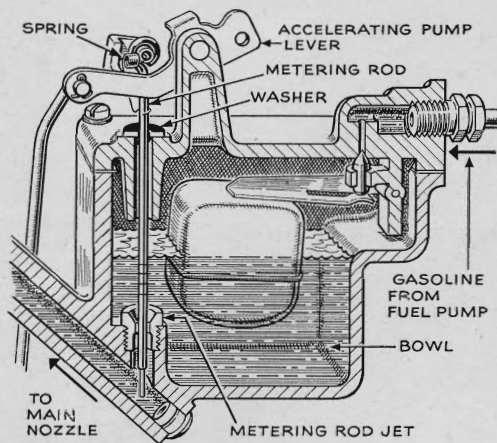

Carburetor Service Tip. In a modern carburetor of the metering-rod type, the little spring at the top of the metering rod and the sealing washer are points that occasionally give trouble. If the spring is missing, the rod may vibrate sufficiently to unseat the washer. This admits full atmospheric pressure to the chamber. Rough engine performance or high fuel consumption may sometimes be traced to this.